

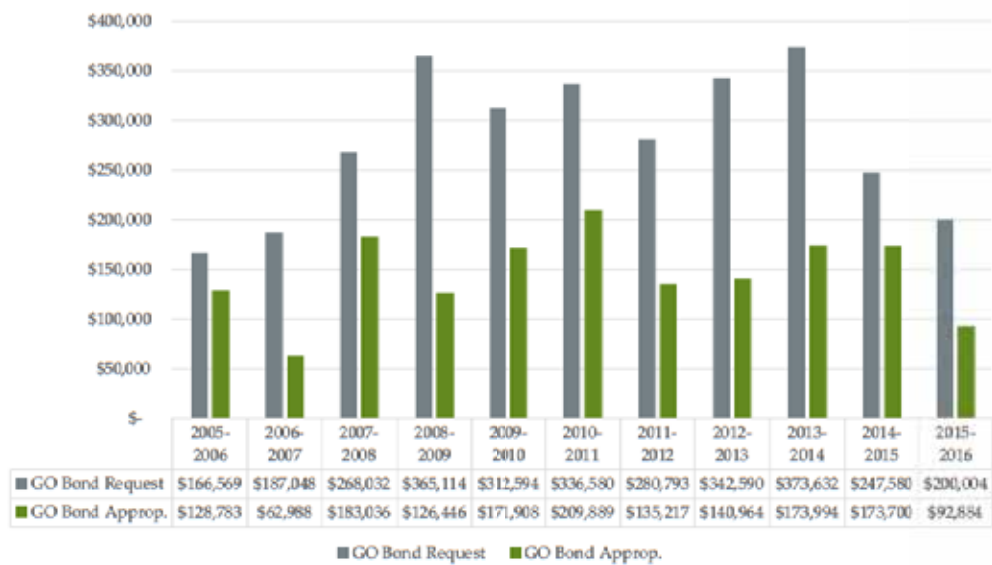

GCA Membership Meeting October 20, 2015



GO Bond CIP Request vs. Appropriation FY 2006 - 2016



Mānoa Campus Community Legal Outreach Center (CLOC)

- **Est. Bid Date: Q1 2016**
- **\$7 million**
- **8,400 square feet**
- **Program Information:**
 - Office and meeting space
 - Clinical and professional training space
 - Support accreditation standards

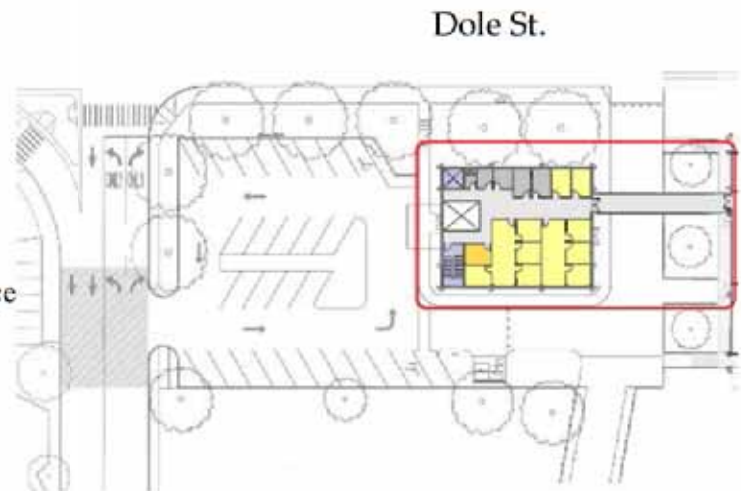

3

Mānoa Campus Design/Build a New Instruction and Research Building

- **Contractor Selection (RFP): Q2 2016**
- **\$45 million**
- **60,000 square feet**
- **Scope:**
 - Design/build a new facility at UH Mānoa for science research and surge space which will include classrooms, teaching labs, research labs, and offices
- **Program Information:**
 - The new Instruction and Research Building will address the declining condition of Snyder Hall and the need for surge space and allow for subsequent renovation of Snyder Hall



4

Mānoa Campus Kennedy Theater – Repairs & Upgrades

- **Est. Bid Date: Q1 2016**
- **\$6.4 million**
- **Scope:**
 - General repairs to stage, platform, spiral stairs, lighting, and access
- **Program Information:**
 - Used for performing arts and classroom spaces



5

UH Mānoa – Piers 34-35 and Sand Island Marine Center Relocation

- **Est. Bid Dates:**
 - **4 separate bid projects (see scope below)**
 - **Items 1 & 2: Q4 2015**
 - **Item 3: Q2 2016**
 - **Item 4: Q4 2016**
- **\$6 million**
- **Scope:**
 1. Security fencing at Piers 34-35
 2. Secured storage area at Sand Island
 3. Renovation of existing facilities at Piers 34-35
 4. Floating pier at Sand Island
- **Program Information:**
 - Relocation of the UHM Marine Center from Piers 43-45 to Sand Island and renovation of facilities at Piers 34-35



6

UH Mānoa - Coconut Island Marine Lab. Bldgs. 1 & 2 and Lilipuna Pier & Seawall Repairs

- **Est. Bid Date: Q1 2016**
- **Marine Lab Bldgs: \$10.5 M**
- **Lilipuna Pier & Seawall: \$5.2 M**
- **Scope:**
 - Renovate interior space for research & teaching labs and perform general exterior repairs
 - Repair concrete piles and replace concrete deck panels



7

Hilo Campus College of Pharmacy

- **Est. Bid Date: Q4 2015**
- **\$30 million**
- **44,969 square feet**
- **Scope:**
 - Construction of a new instructional facility for the College of Pharmacy at UH Hilo which will include classrooms, teaching labs, offices, and related spaces.
- **Program Information:**
 - Development of a permanent facility to replace the temporary facility, as required for ACPE accreditation.



8

West O'ahu Campus

Design/Build a Science Technology, and Creative Media Facility

- **Contractor Selection (RFP): Q3 2016**
- **\$38 million**
- **30,000 square feet**
- **Scope:**
 - Design/build a new Science, Technology, and Creative Media facility which will include classrooms, offices, laboratories, and related spaces.
- **Program Information:**
 - Facility will accommodate state-of-the-art media production facilities and provide instructional space for science and technology related programs

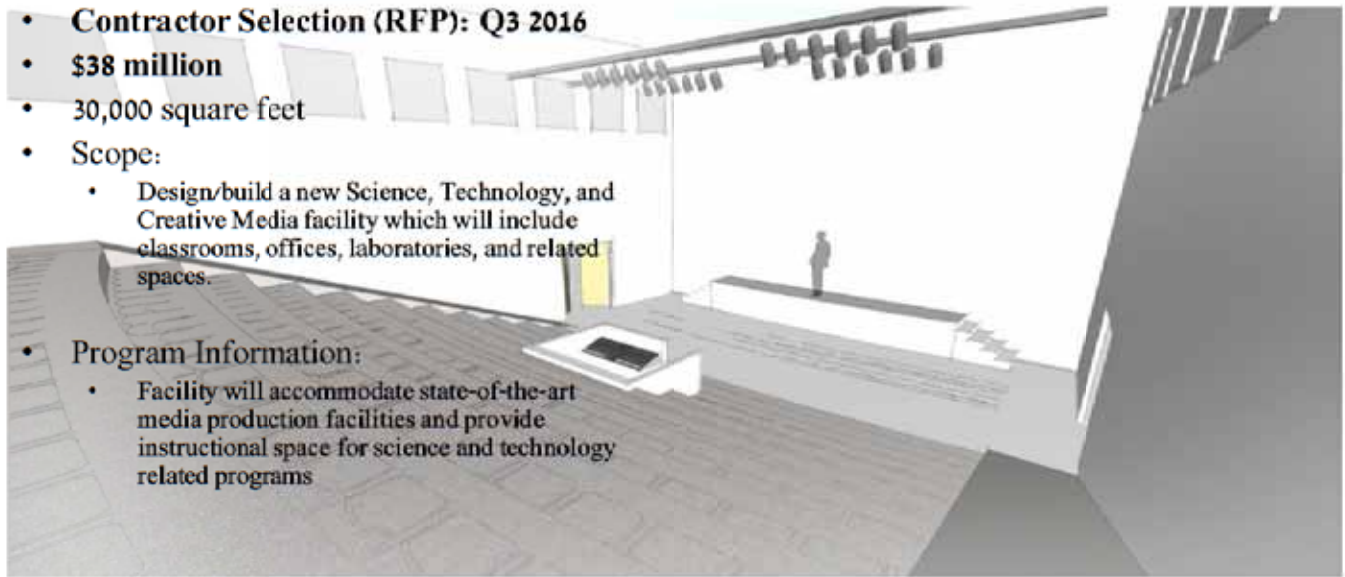

9

West O'ahu Campus

Administration and Allied Health Facility

- **Est. Bid Date: Q2 2016**
- **\$36 million**
- **43,422 square feet**
- **Scope:**
 - Construction of an Administration and Allied Health Facility which will include classrooms, offices, laboratories, and related spaces.
- **Program Information:**
 - Baccalaureate programs in physical, occupational & speech therapy; respiratory care; long-term/geriatric care, medical technical, and hospital administration
 - Consolidate campus administration offices



10

Honolulu Community College Construction of Advanced Technology Training Center

- **Est. Bid Date:**
Pending City sewer connection approval
- **\$36 million**
- **47,957 square feet**
- **Scope:**
 - Construction of a new advanced science and technology building at Honolulu Community College which will include classrooms, offices, and laboratories.
- **Program Information:**
 - HCC has established itself as the technological training center of the Pacific. The new facility will enhance HCC's science and technology capabilities to develop a skilled work force.



11

Leeward Community College Repair/Refurbish Theater

- **Est. Bid Date: Q1 2016**
- **\$8 million**
- **Program Information:**
 - The theater is heavily utilized by LCC's performing arts programs and by faculty, staff, students, and the general public.



12

UNIVERSITY OF HAWAII

Upcoming Projects (between \$2 - \$5 million)

<u>CAMPUS</u>	<u># OF PROJECTS</u>	<u>ESTIMATED CONSTRUCTION COST (\$M)</u>
MANOA	17	\$65.3
HILO	5	\$13.1
WEST OAHU	4	\$13.4
COMMUNITY COLLEGES	8	\$18.8
<u>TOTAL</u>	<u>34</u>	<u>\$110.6</u>



UNIVERSITY of HAWAII®



MAHALO